

Case erector





CF-10T Case erector

Model	CF-10T
Air pressure	4Kg/cm ²
Case size	L 200-600 x W 150-480 x H 120-480 mm (The height is the standard sealing height of carton sealer machine)
Erecting type	Fold bottom covers of carton and can be used as the platform for packing products
Electric adoptions	"AIRTAC" cylinder, "AIRTAC" Regulator valve, "AIRTAC" Pneumatic control valve, "Festo" Air time-delay commutator
Worktable height	Feet cup: 600~780 mm (adjustable) Castor wheel: 700~880 mm (adjustable)
Outside dimension	L 1500 × W 900 × H 780mm (feet cup)/ 880 mm (Castor wheel)
Machine weight	80kg



CF-20T Case erector

- Alarm when lack tape or case

Model	CF-20T
Power supply	220V 50Hz 500W (optional)
Air pressure	6kg/cm ²
Tape width	4.8-6.0cm
Working speed	0-12cases/min
Case Size	L 330-530 W 165-310 (base carton size must be suitable as below : 650>W/2+H>280 L change scope 150mm)
Machine appearance dimensions	L 1900mm × W 1900mm × H 1350mm
Machine weight	400kg
Environment conditions	Humidity ≤ 98% Temperature 0-40°C



world advanced packing system

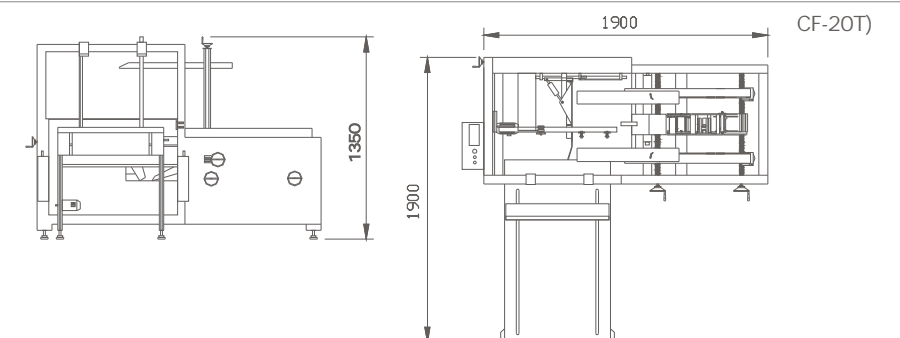

CF-30T

Case erector

• Alarm when lack tape or case

Model	CF-30T
Power supply	380V 50Hz 1.8KW
Air pressure	6kg/cm ²
Tape width	4.8-7.2cm tape max. Length 2km
Working speed	20-25cases/min work height 1120+-50mm
Case Size	250 < L < 410 mm 165 < W < 300mm 330 < W + H < 640 mm L+W<700
Machine appearance dimensions	L 2800mm × W 1560mm × H 2250mm
Machine weight	1100kg
Environment conditions	Humidity ≤ 98% Temperature 0-40°C
Optional	with "Nordson" hot glue machine



CF-30TB

Case erector

• Alarm when lack tape or case

Model	CF-30TB
Power supply	380V 50Hz 1.8KW
Air pressure	6kg/cm ²
Tape width	4.8-7.2cm tape max. Length 2km
Working speed	20-25cases/min work height 1120+-50mm
Case Size	250 < L < 410 mm 165 < W < 300mm 330 < W + H < 640 mm L+W<700
Machine appearance dimensions	L 4800mm × W 1560mm × H 2250mm
Machine weight	1100kg
Environment conditions	Humidity ≤ 98% Temperature 0-40°C
Optional	with "Nordson" hot glue machine



CF-40T

Case erector (BOPP or Kraft paper tape type)

- Alarm when lack tape or case

Model	CF-40T
Power supply	380V ± 10%/50Hz, 2.5KW (Three-phase four-wire system)
Air pressure	4-6g/cm ²
Working speed	40 cases/min
Case Size	Custom-made
Sealing specification	Custom-made
Sealing tape	Kraft paper or BOPP tape
Electric adoptions	Adopt TAIWAN "CPG" or "ONG LI" motor
Worktable height	1000-1200mm
Outside dimension	L4150 × W1530 × H2000mm
Transport packing size	L 4250 X W 1630 X H2100mm (14.55m ³)
Machine weight	650kg



world advanced packing system

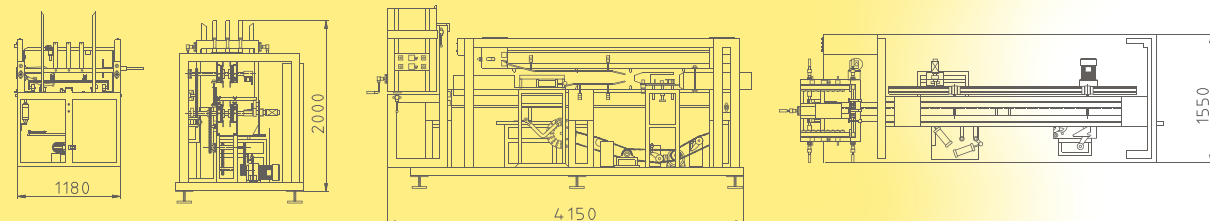

CF-40T-H

Case erector (hot glue type)

- Alarm when lack tape or case

Model	CF-40T-H
Power supply	380V ± 10%/50Hz, 2.5KW (Three-phase four-wire system)
Air pressure	4-8Kg/cm ²
Tape width	4.8-7.2cm tape max. Length 2km
Working speed	20~60 cases/min
Case Size	Custom-made
Sealing specification	Custom-made
Sealing type	Hot glue
Outside dimension	L4250 × W2000 × H1700mm
Electric adoptions	Adopt TAIWAN "CPG" or "DONG LI" motor
Worktable height	1000mm
Machine weight	1000kg

